

# H-PRD-4P2

## HIGH PERFORMANCE 2" END PLUG PRESSURE RELIEF DEVICES 2" 瓶塞式压力释放阀

### Key Features

GFI's 2" end plug pressure relief devices uses a design optimized for maximum heat transfer to create a fast acting high flow PRD. Offered with a wide range of options these devices can be configured to meet the needs of all end plug applications.

- Center positioned vent port
- High flow fast acting design
- Cadmium free eutectic technology
- Nominal working pressure 35 MPa
- Working temperature -40° to +85° C
- Light weight machined aluminum body
- Suitable for use with all cylinder types

### 主要特性

公司GFI 2" 的瓶塞式压力释放阀系列产品设计时最大化了热量交换的速度，所以响应快、流量大。本产品接头规格很全，可以根据客户的要求进行定制。

- PRD导出口居中；
- 流量大，响应快；
- 非镉易融合金技术；
- 最大工作压力35MPa；
- 工作温度范围-40℃ to 85℃；
- 轻量化铝制机体；
- 兼容所有气瓶类型。



Engineered to meet International Standards and Regulations  
• Certified to EC79/2009 and HPRD1.

- All designs are subjected to rigorous qualification testing
- Including long-term endurance cycling, severe vibration, and accelerated cyclic corrosion.

# SPECIFICATIONS 技术参数

H-PRD-4P2	
<b>GENERAL INFORMATION 基本参数</b>	
APPLICATION 应用	Suitable for all cylinder types 气瓶阀 Safety Device for 2" neck Type 1 / Type 2 / Type 3 / Type 4 cylinders
DESIGN 设计	Thermally activated PRD
BODY MATERIAL 机体材料	Extruded Aluminum, anodized
FUEL TYPE 燃气类型	Hydrogen
NOMINAL WORKING PRESSURE 最大工作压力	35 MPa (5,076 psig)
<b>PERFORMANCE 性能</b>	
FLOW RATE WHEN ACTIVATED (CV) 最大流量	0.76
WORKING TEMPERATURE 工作温度	-40°C to 85°C (-40°F to 185°F)
T-PRD OPERATION T-PRD激活	110 +/- 5°C
T-PRD ORIFICE T-PRD有效通经	Up to 5.7 mm equivalent
BURST DISK (OPTION) 爆破片 (可选)	Available 可选
<b>CONNECTIONS 连接</b>	
CYLINDER CONNECTION 瓶口连接	2"-12 UN
VENT THREAD TYPE Vent孔连接	9/16" - 18 UNF
<b>APPROVALS 认证</b>	
CERTIFICATIONS 认证	EC79, HPRD1

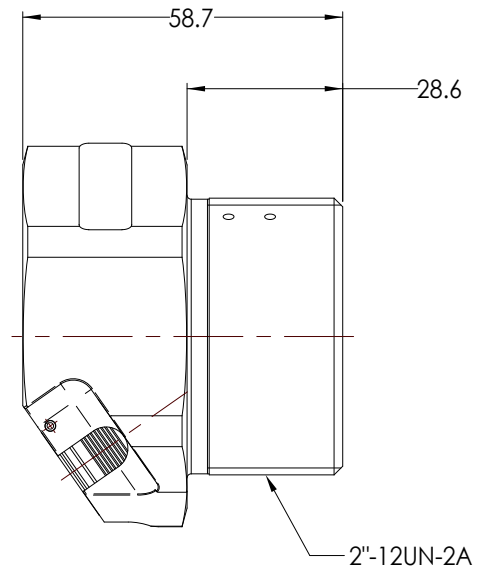
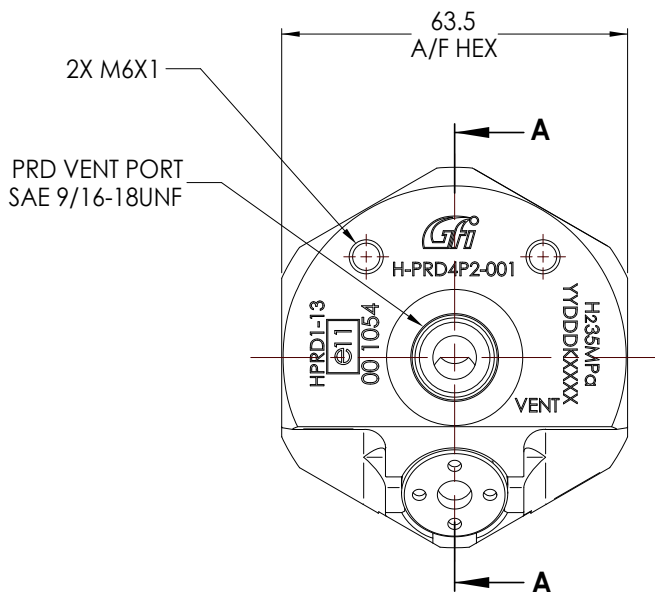

IATF 16949:2016 registered  
a Westport Fuel Systems company

